

# SINGLE - POINT PLATFORM LOAD CELL

## MODEL :GPS Series

### FEATURES :

- ❖ Tool Steel Construction for Harsh Application
- ❖ Low Profile
- ❖ Single Point Capability with minimum error for off-centre loading
- ❖ Supports Platform Scale with size 600 x 600 (mm)
- ❖ Compact, Light Weight & Economical

### APPLICATIONS :

- ❖ Smaller Sized Economical Platform Scales
- ❖ Check Weighers
- ❖ Bag Weighers

### DESCRIPTION :

This is a strain Gage based low profile bending beam Load Cell for platform size of 600 x 600 (mm). It is an economical cell for smaller size low profile platform scales. It is off center load compensated and is rugged to take shock loads.

### PERFORMANCE SPECIFICATION :

<b>Standard Capacities (Kgf.)</b>	: 75, 100, 120, 150, 200, 250, 300, 400
<b>Excitation Voltage</b>	: 10 VDC - Maximum 15 VDC
<b>Nominal Output</b>	: 2.0 mV/V
<b>Non - Linearity</b>	: < ± 0.025 % FSO (Full Scale Output)
<b>Hysteresis</b>	: < ± 0.01 % FSO
<b>Non - Repeatability</b>	: < ± 0.02 % FSO
<b>Creep (30 minutes)</b>	: < ± 0.03 % FSO
<b>Zero Balance</b>	: ± 1.0 % FSO
<b>Input resistance</b>	: 390 ± 15 Ohms
<b>Output Resistance</b>	: 350 ± 5 Ohms
<b>Insulation Resistance</b>	: > 1000 Mega Ohms
<b>Safe Overload</b>	: 150% of Rated Capacity
<b>Ultimate Overload</b>	: 250 % of Rated Capacity
<b>Temperature Compensated Range</b>	: 0-60° C
<b>Temperature Effect on Output</b>	: < 0.0015 % FSO/° C
<b>Temperature Effect on Zero</b>	: < 0.0020 % FSO/° C
<b>Platter Size</b>	: 600 x 600 mm
<b>Eccentric Load Effect</b>	: < 0.02% of FSO at 1/3 rated load placed within 300mm radius from the center of Load Cell
<b>Deflection</b>	: < 0.5 mm at FSO
<b>Tightening Torque</b>	: 5 m. kg.
<b>Finish &amp; Construction</b>	: Electroless Nickel plated Tool Steel
<b>Environmental Protection Class</b>	: IP65

## GLOBAL

WEIGHTRACK INDIA PVT. LTD.

**ELECTRICAL TERMINATION**

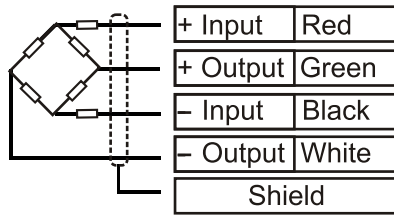

4 CORE SCREENED CABLE - 3 mtrs.

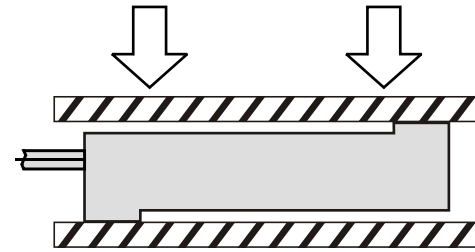

M8 X 16 DEEP (9 PLACES)

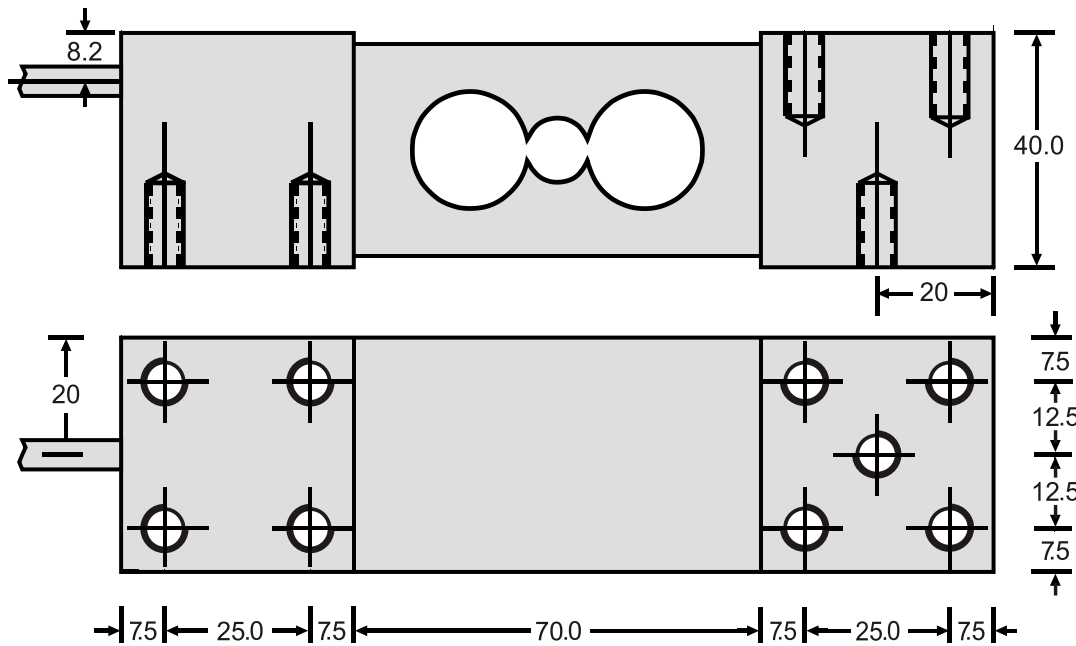

ARROW SHOWS LOAD DIRECTION FOR +VE OUTPUT



**TOP VIEW**

All dimensions are in mm.

**GLOBAL**

**WEIGHTRACK INDIA PVT.LTD.**

**PLOT NO- 623(P),HANSPAL**

**(NEAR PURI CENAL),BHUBANESWAR-752101,ODISHA**

**Tel:-09040077885, 07381031700,Telefax: 0674-2463002**

**E-mail: sales@weightrackindia.com,support@weightrackindia.com**

**info@weightrackindia.com,weightrack12@gmail.com**

**Web: www.weightrackindia.com**